

VOLKSWAGEN
MK8 GOLF R
PK439

Intake Instructions



Parts List

SILICONE INTAKE PIPE

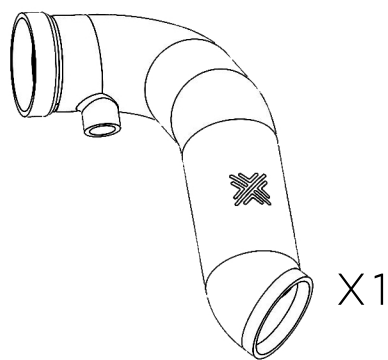

HEATSHIELD

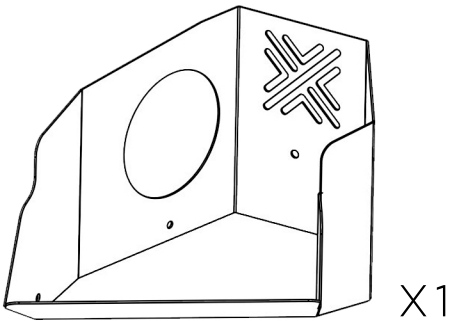

FILTER

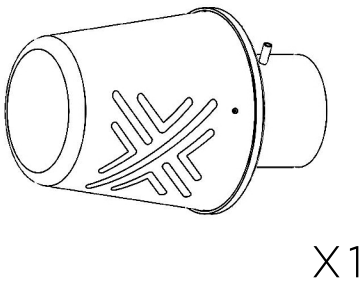

TURBO ADAPTOR

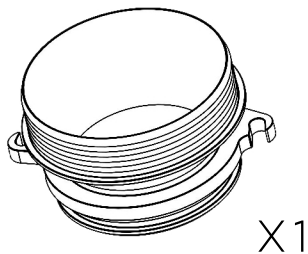

BLOW OFF CONNECTOR

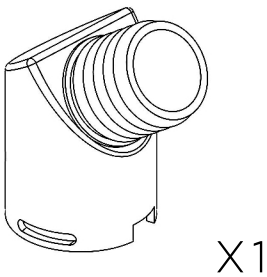

FRONT HEATSHIELD BRACKET 1

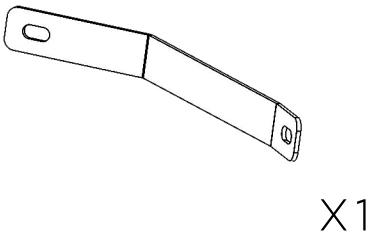

FRONT HEATSHIELD BRACKET 2

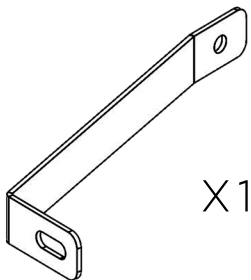

REAR HEATSHIELD BRACKET

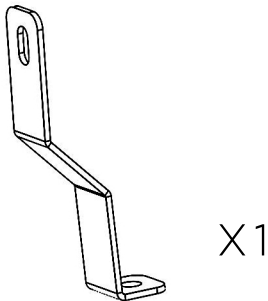

FLAP RETENTION BRACKET

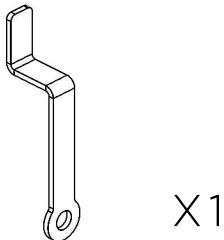

FILTER BRACKET

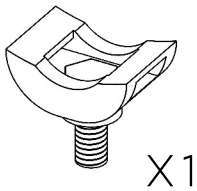

FILTER BRACKET

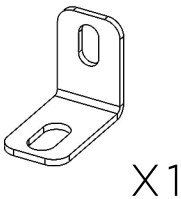

HOSE CLAMP
90MM>110MM

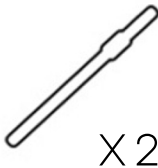

M6 X 16MM CAP
HEAD

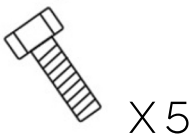

M6 NYLOCK
NUT



M6 WASHER



M8 STEEL WASHER



M8 NYLOCK NUT



Step 1

Loosen the hose clamps on the back & the front of the intake pipe

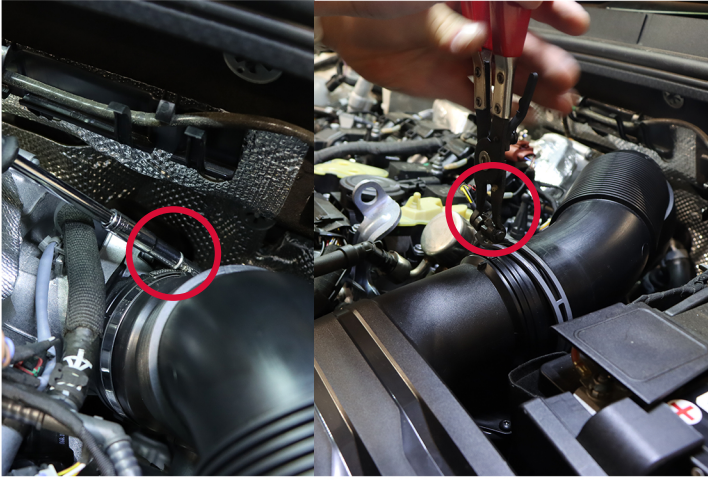

Step 2

Disconnect the intake pipe from the air-box



Step 3

Remove the hose from the front of the air-box



Step 4

Remove air-box from the engine bay



Step 5

Depress both locking tabs on the breather hose and pull it away from the intake pipe



Step 6

Remove battery strap nut

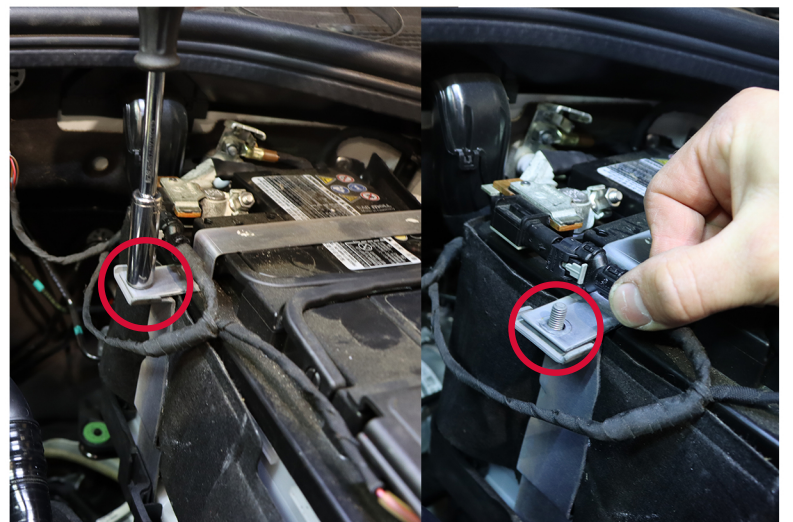

Step 7

Disconnect battery sensor then loosen and remove negative battery terminal (keep clear until ready to re-install)

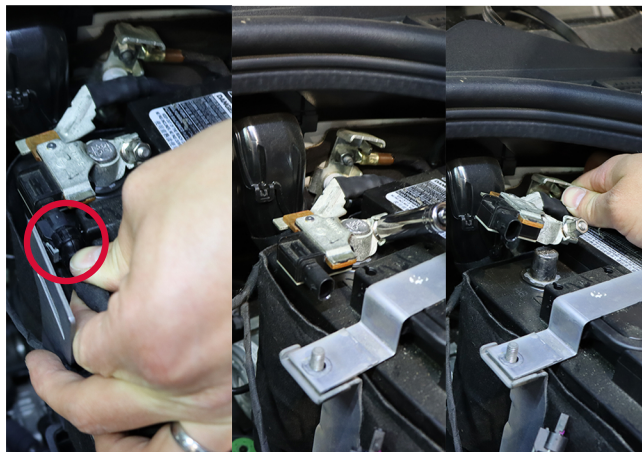

Step 8

Remove positive terminal cover then disconnect and remove terminal (keep clear until ready to re-install)

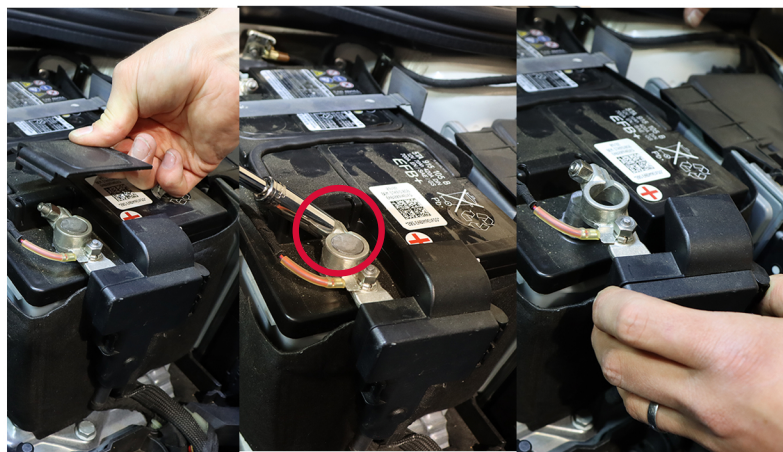

Step 9

Remove battery strap



Step 10

Remove bolt from battery pressure plate and lift out



Step 11

Remove battery from the car

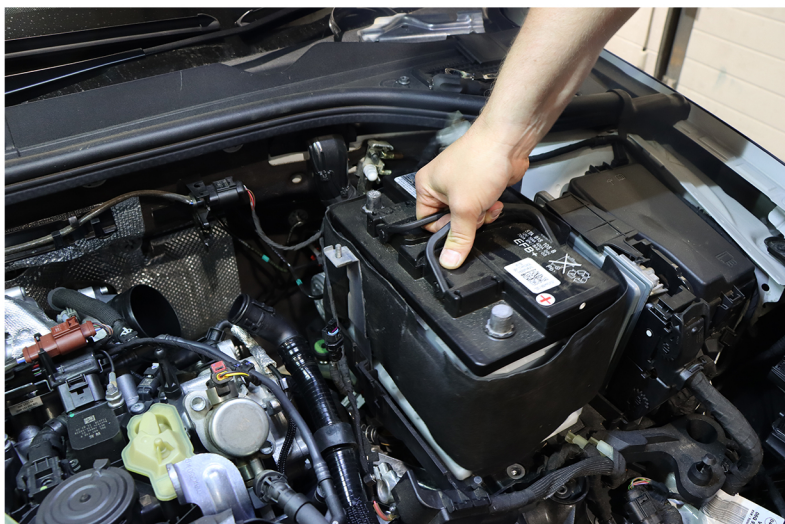

Step 12

Remove the battery cage bolt, flip the battery cage 180° then back bolt down

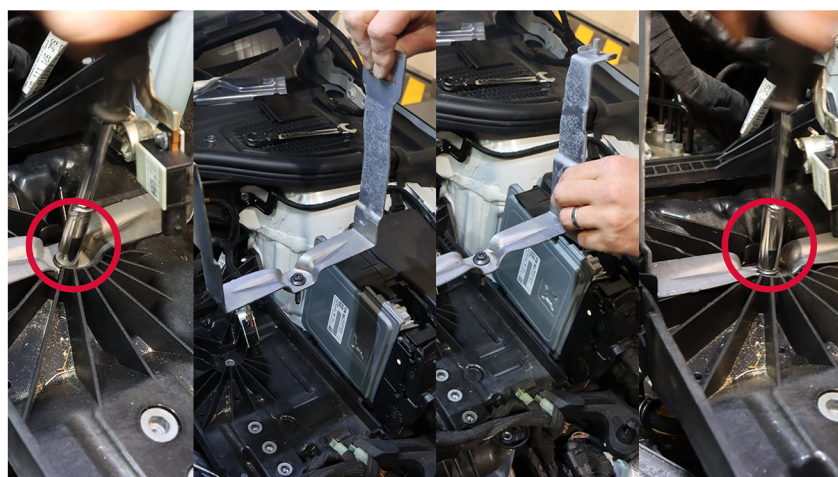

Step 13

Place battery back into car (make sure the positive terminal is facing towards the front of the car)



Step 14

Re-install battery pressure plate & re-connect battery sensor

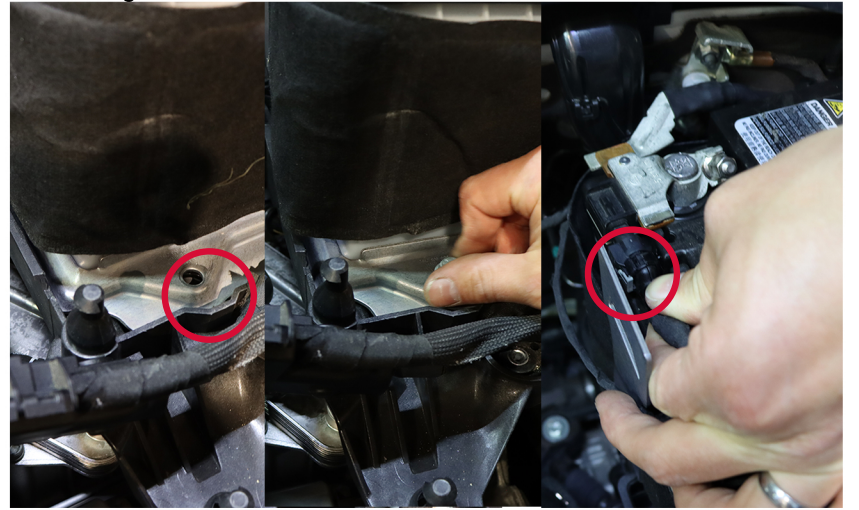

Step 15

Re-install battery strap

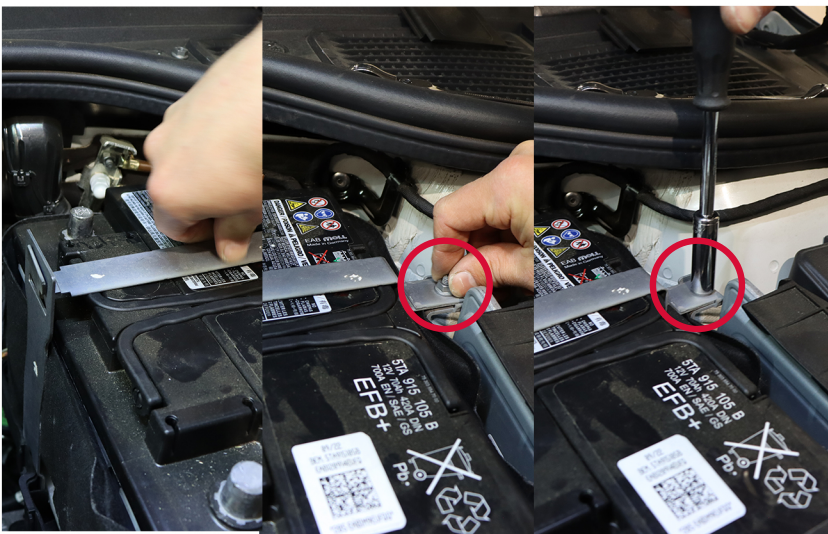

Step 16

Re-install positive terminal and replace cover

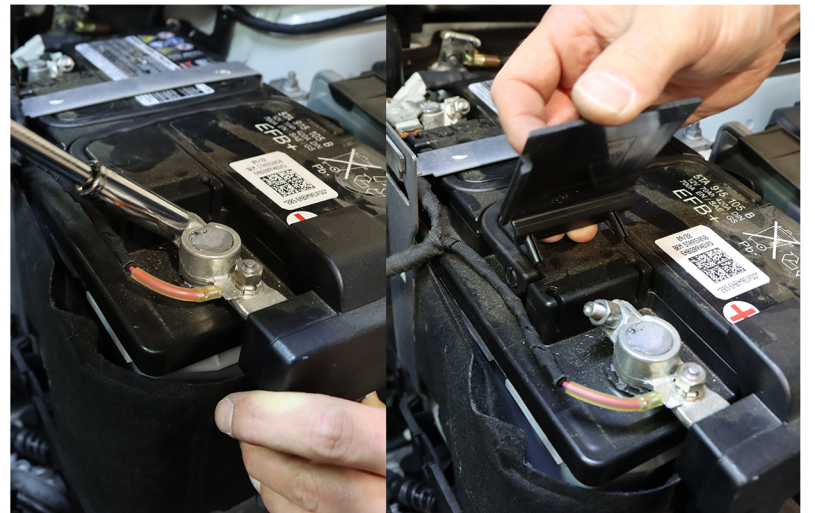

Step 17

Re-install negative terminal



Step 18

Remove connector from fire wall and disconnect lambda probe loom



Step 19

Un screw OEM turbo adaptor and remove

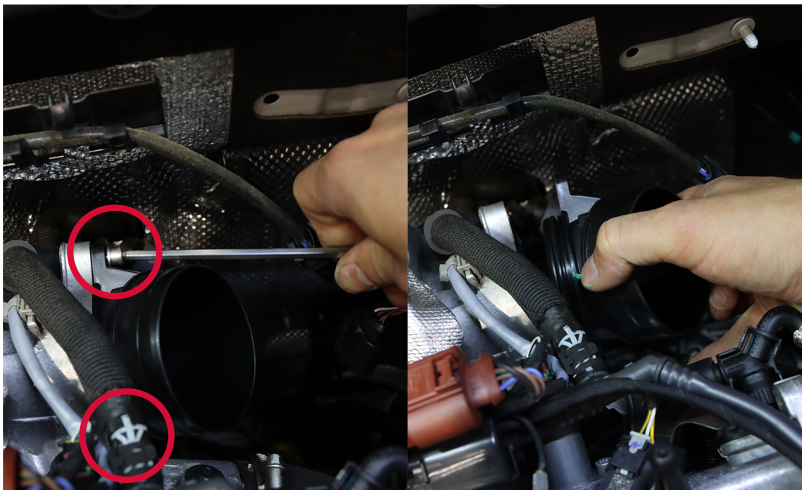

Step 20

Remove rubber O ring from the old adaptor and place onto the new one
(Do not use sharp tools)



Step 21

Screw M6 Cap heads 2-3 turns into the turbo flange as pictured. Push the new turbo adapter into place and rotate the adaptor until the locating hooks are in place

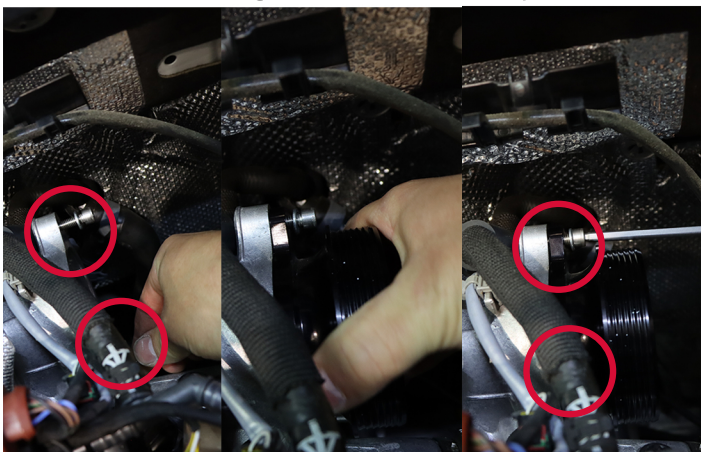

Step 22

Place the hose clamps onto both sides of the silicone hose



Step 23

Attach blow off connector to the silicone hose



Step 24

Re-attach hose to the blow off connector



Step 25

Attach silicone hose to turbo adaptor and loosley tighten hose clamp

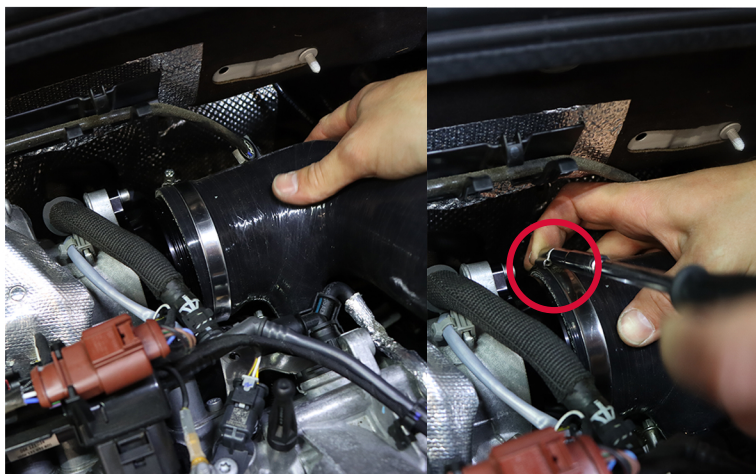

Step 26

Re-connect plugs for the lambda probe loom and place back into housing & connect back to the fire wall



Step 27

Take out the screws on either side of the air duct

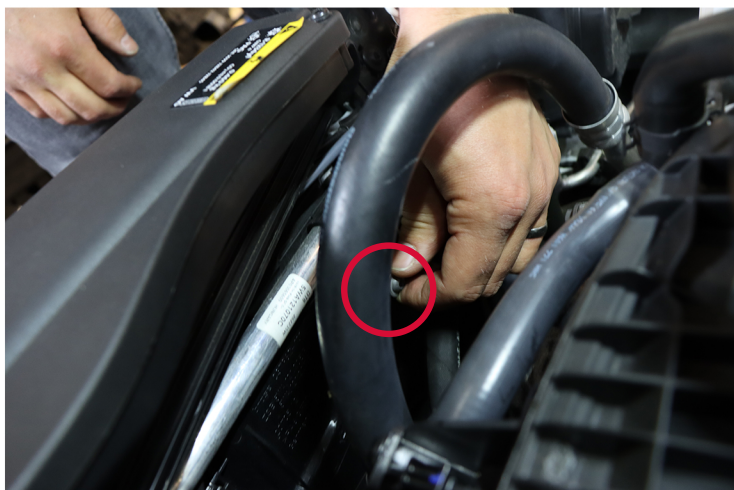

Step 28

Screw in flap retention bracket using drivers side hole on the air duct

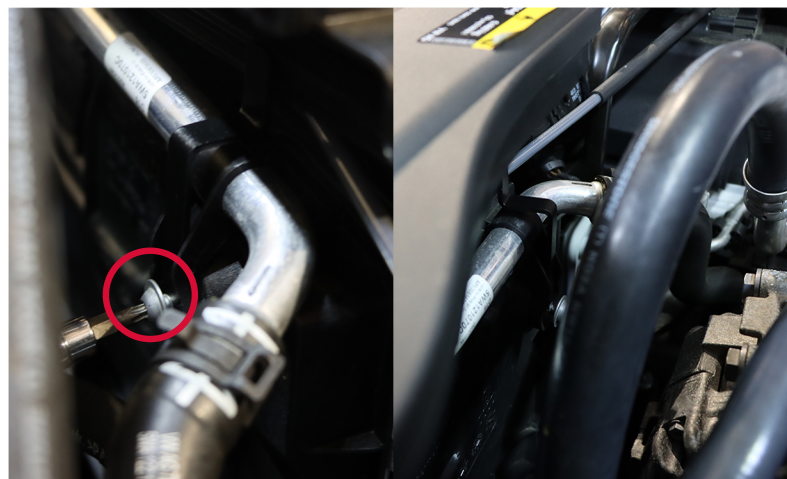

Step 29

Attach mini bracket to the filter mounting bracket



Step 30

Fit the combined brackets to heatshield



Step 31

Loosley attach rear heatshield bracket



Step 32

Place heatshield into engine bay

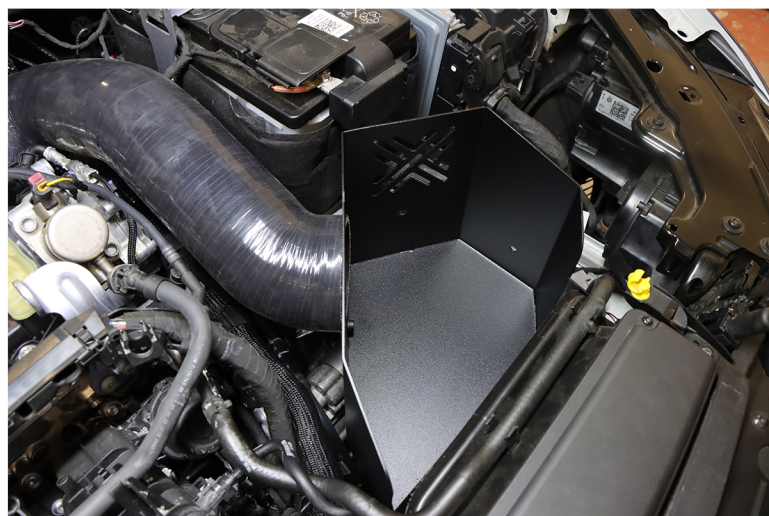

Step 33

Line up the rear heatshield bracket with hole shown & tighten down

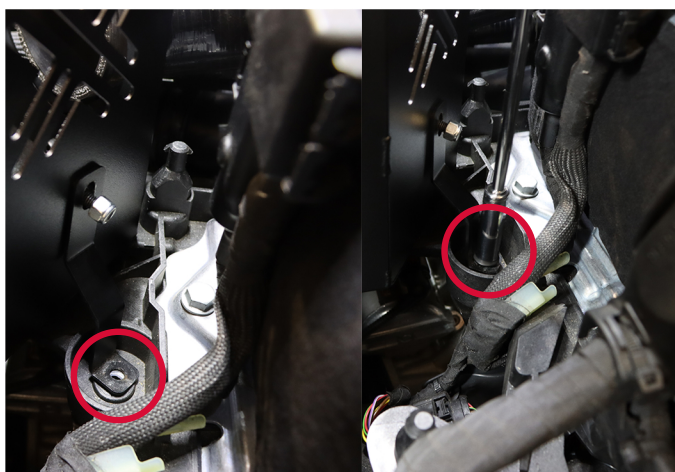

Step 34

Attach heatshield bracket 2 to the heatshield and secure in hole near passenger side bonnet catch.

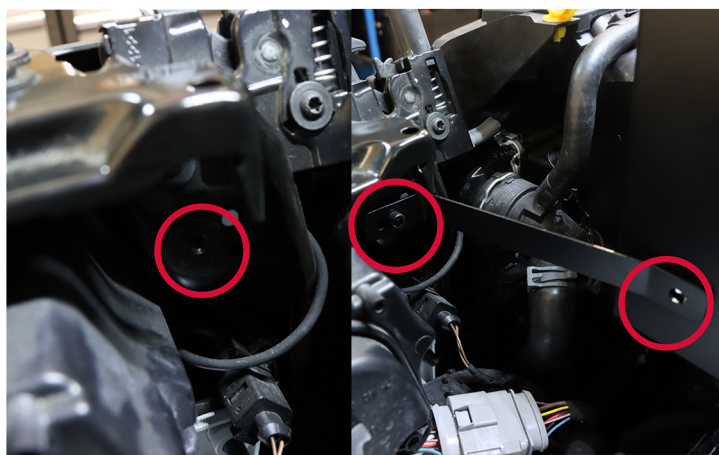

Step 35

Tighten the nut & screw

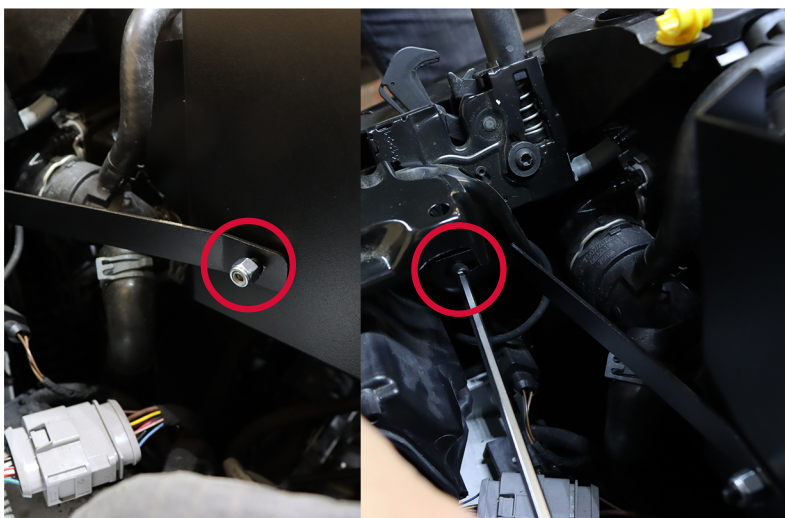

Step 36

Attach heatshield bracket 1 to the heatshield and place the other end behind the passenger side air duct hole and screw down

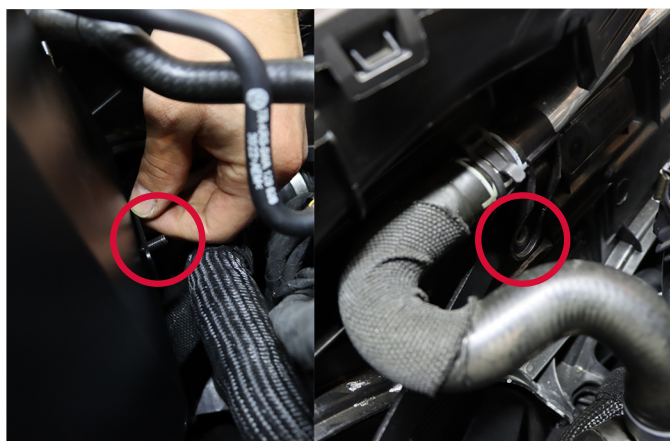

Step 37

Attach filter to silicone hose

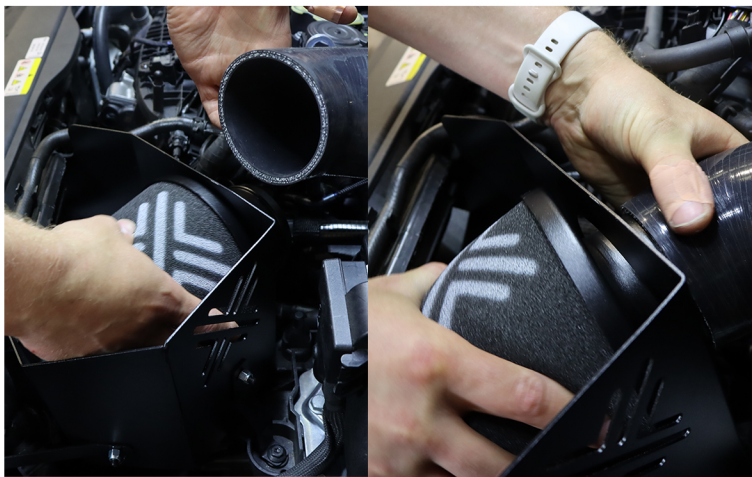

Step 38

Re-attach hose to filter neck



Step 39

Adjust hose clamp so it sits over filter neck



Step 40

Make sure all hose clamps & bolts are tight

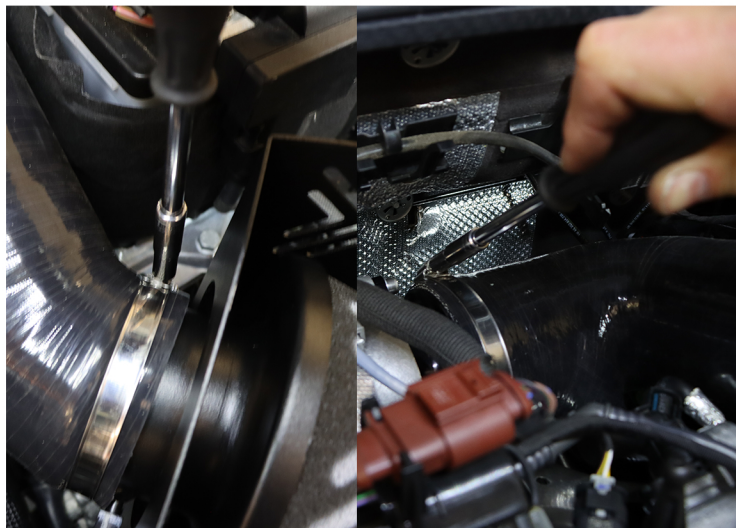

Step 41

You are ready to get back on the road!

