

HYUNDAI I20N PK438

Intake Instructions



Parts List

x1 INTAKE PIPE

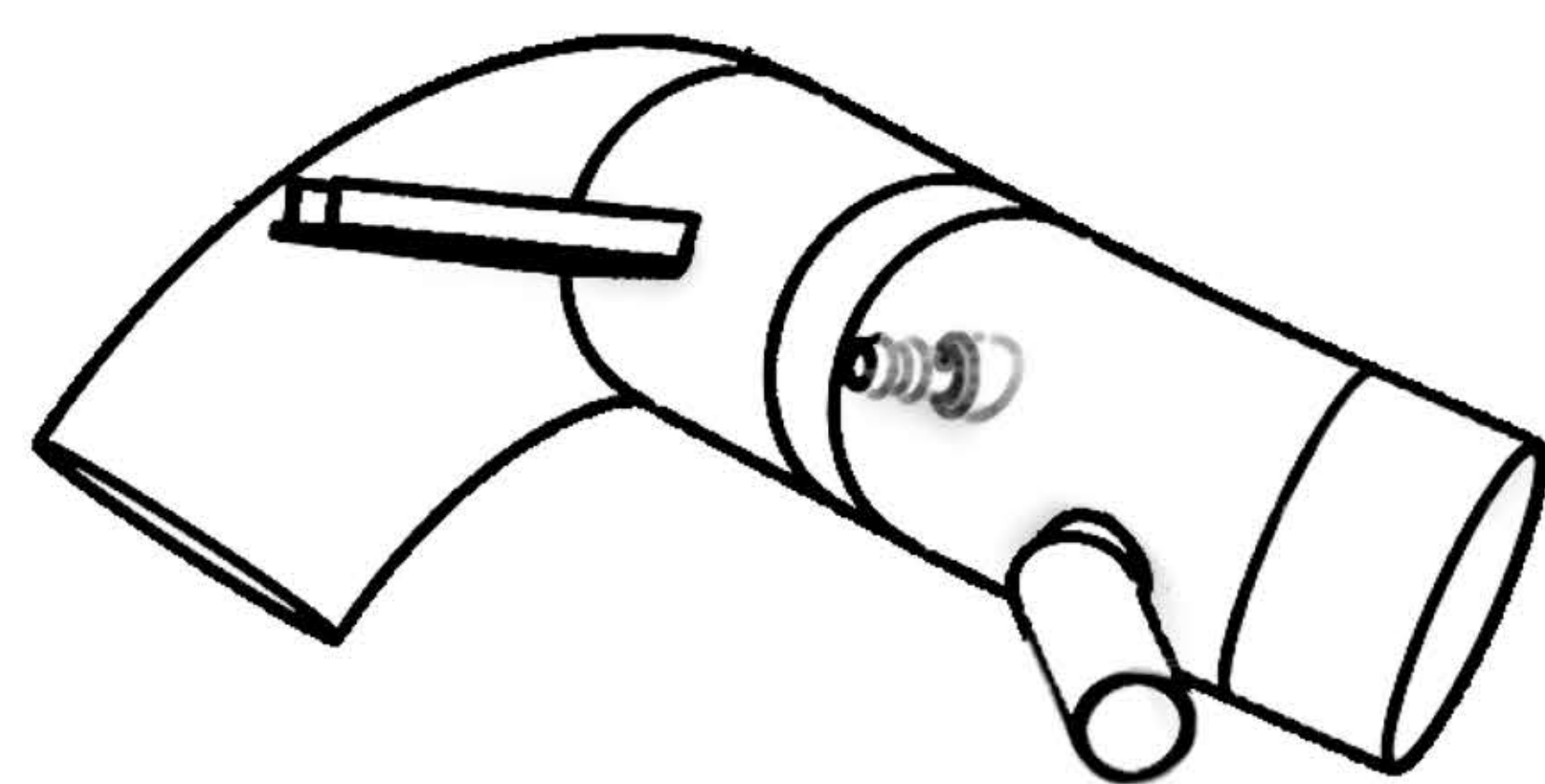

x1 HEAT SHIELD

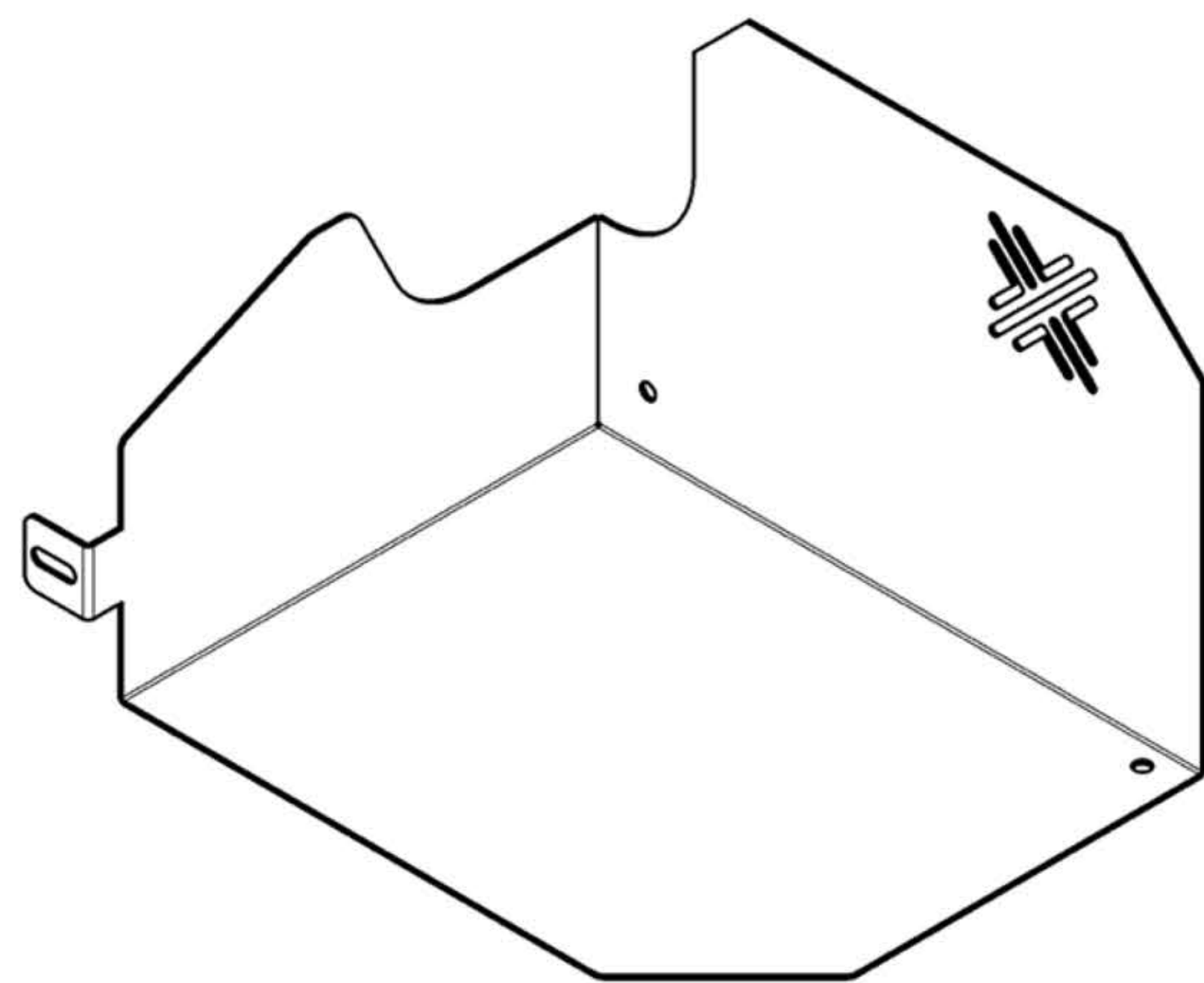

x1 FILTER



x1 SILICONE

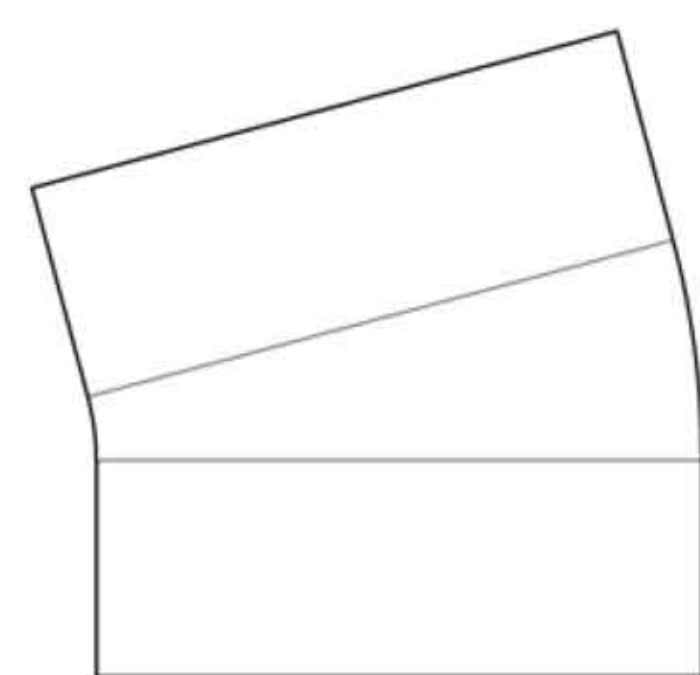

x1 HEAT SHIELD BRACKET



x1 50MM-70MM JUBILEE CLIP



x1 ANTI VIBRATION MOUNT

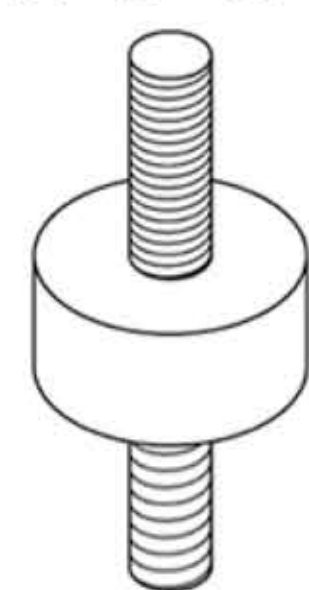

x1 HEAT SHIELD BRACKET

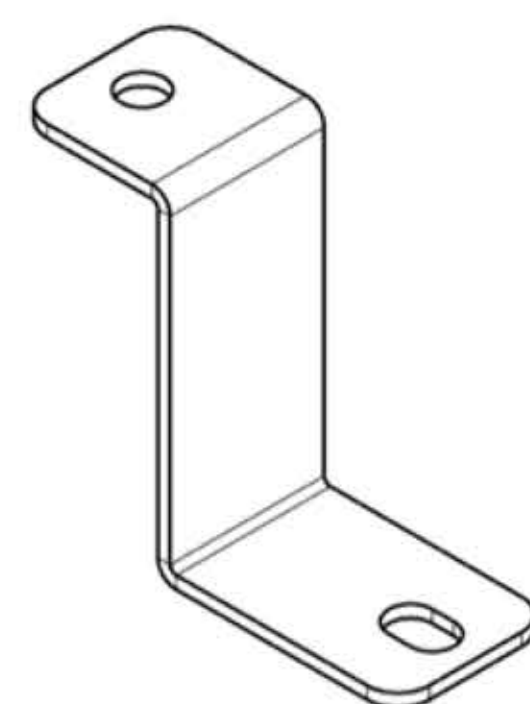

x3 70MM-90MM JUBILEE CLIP



x3 M6 NYLOCK NUTS



x3 M6 CAPHEAD SCREWS



x1 SILICONE REDUCER

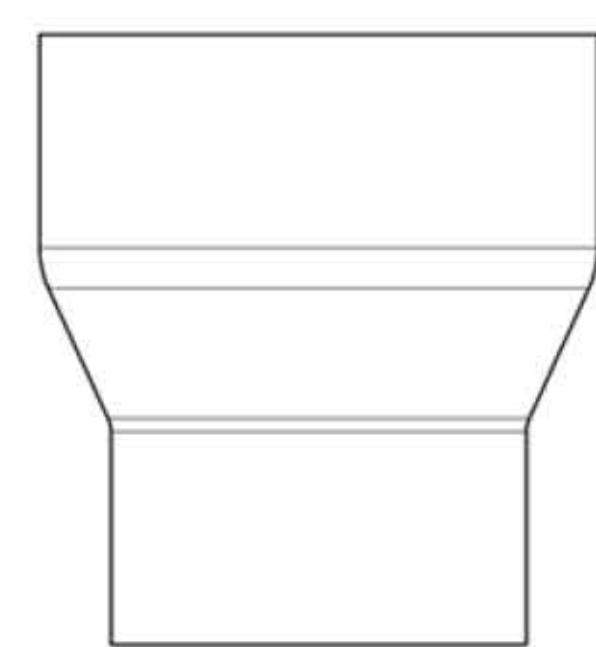

x1 M6 WASHER



STEP 1

REMOVE THE 2 HOSE CLAMPS CONNECTING TO THE STANDARD INTAKE PIPE.

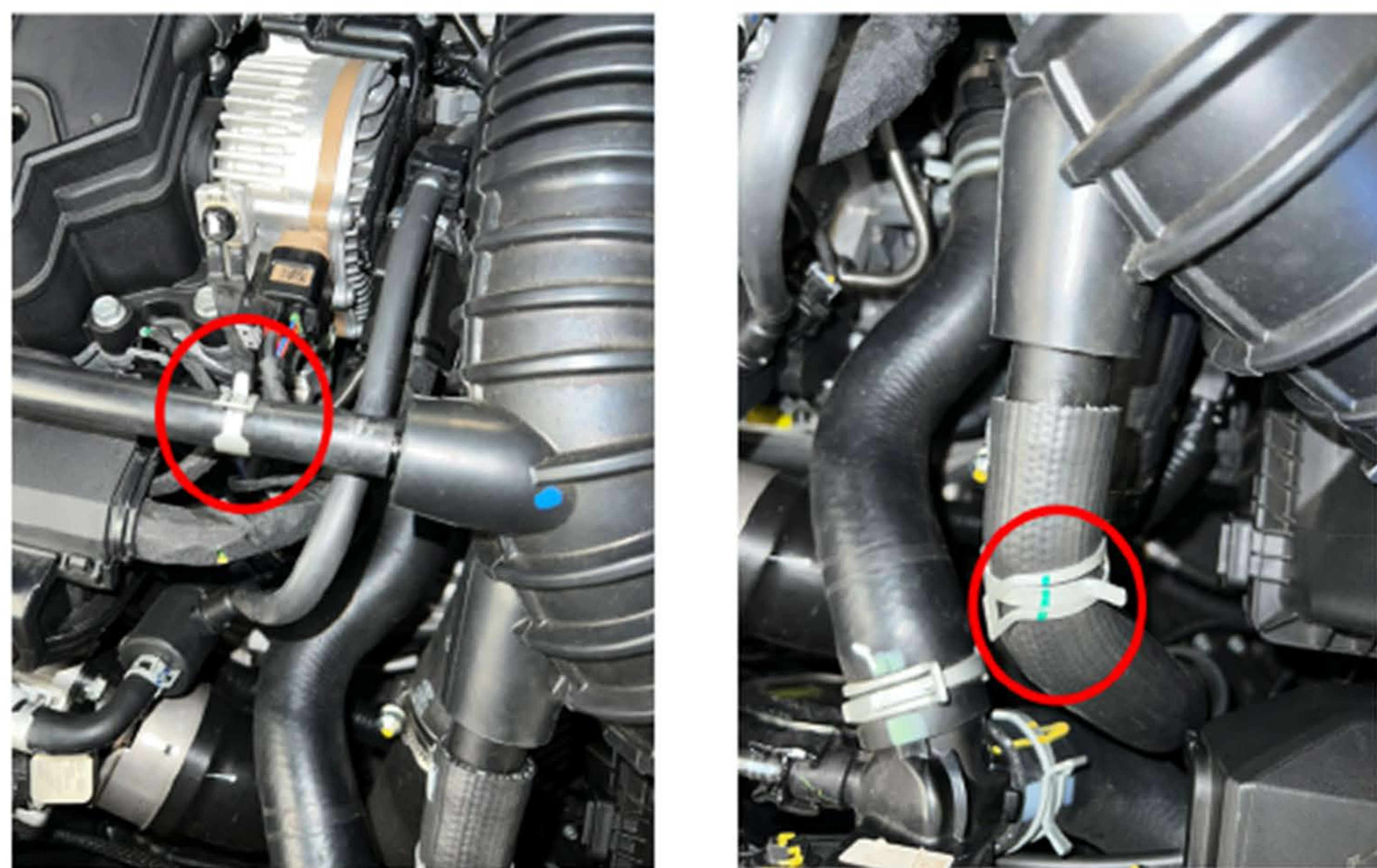

STEP 2

REMOVE THE JUBILEE CLIP CONNECTING THE INTAKE PIPE TO THE TURBO.



STEP 3

REMOVE THE 3 BOLTS HOLDING THE STANDARD AIRBOX IN PLACE.

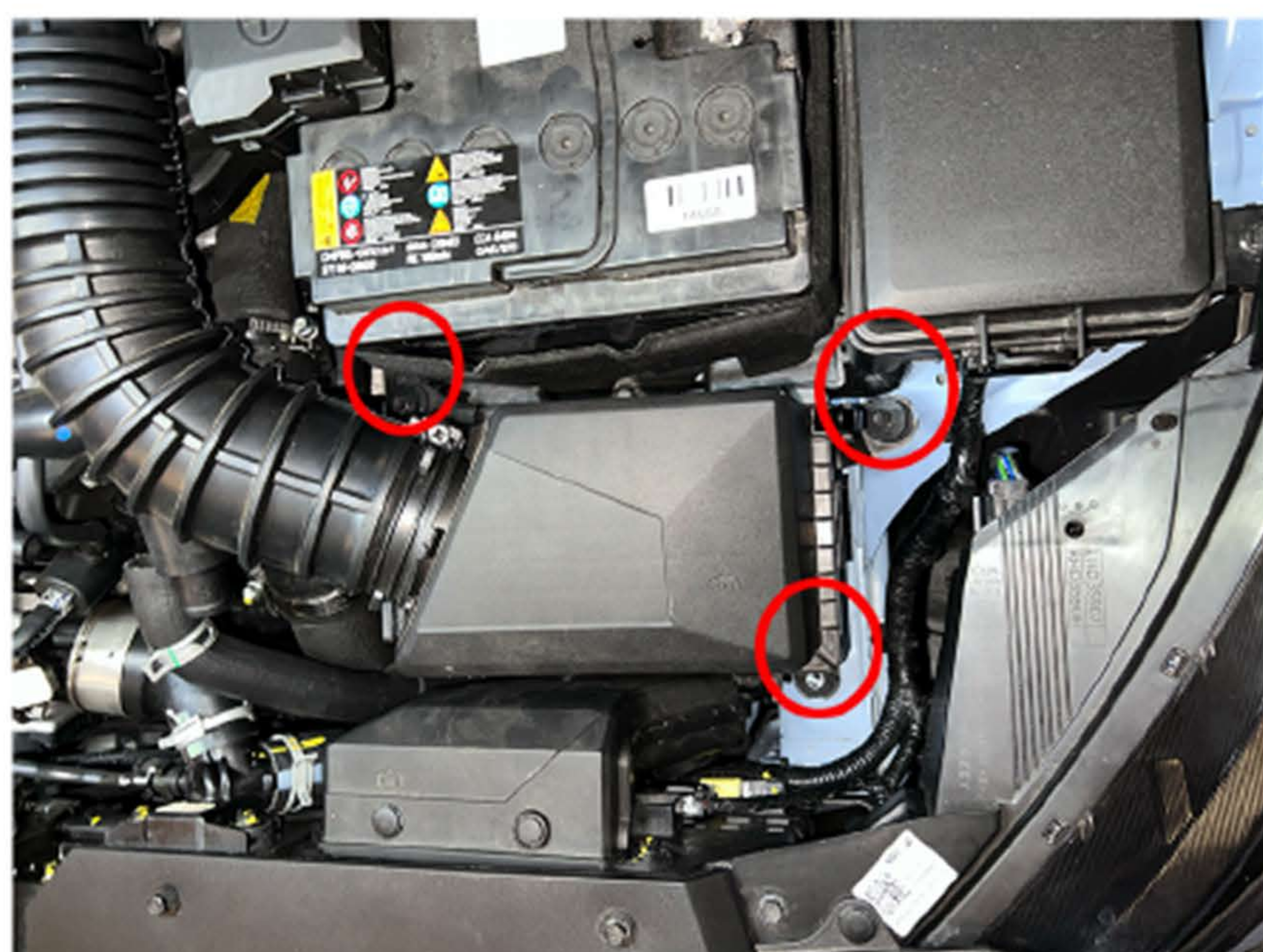

STEP 4

REMOVE THE CLIPS HOLDING DOWN THE STANDARD AIRBOX TO THE FRONT OF THE CAR.



STEP 5

YOU CAN NOW REMOVE THE STANDARD AIRBOX LIKE PICTURED BELOW.



STEP 6

LOOSELY FIT THE BRACKETS TO THE HEAT SHIELD TO HELP SAVE TIME WITH THE INSTALLATION.



STEP 7

FIT THE ANTI-VIBRATION MOUNT AS CIRCLED BELOW

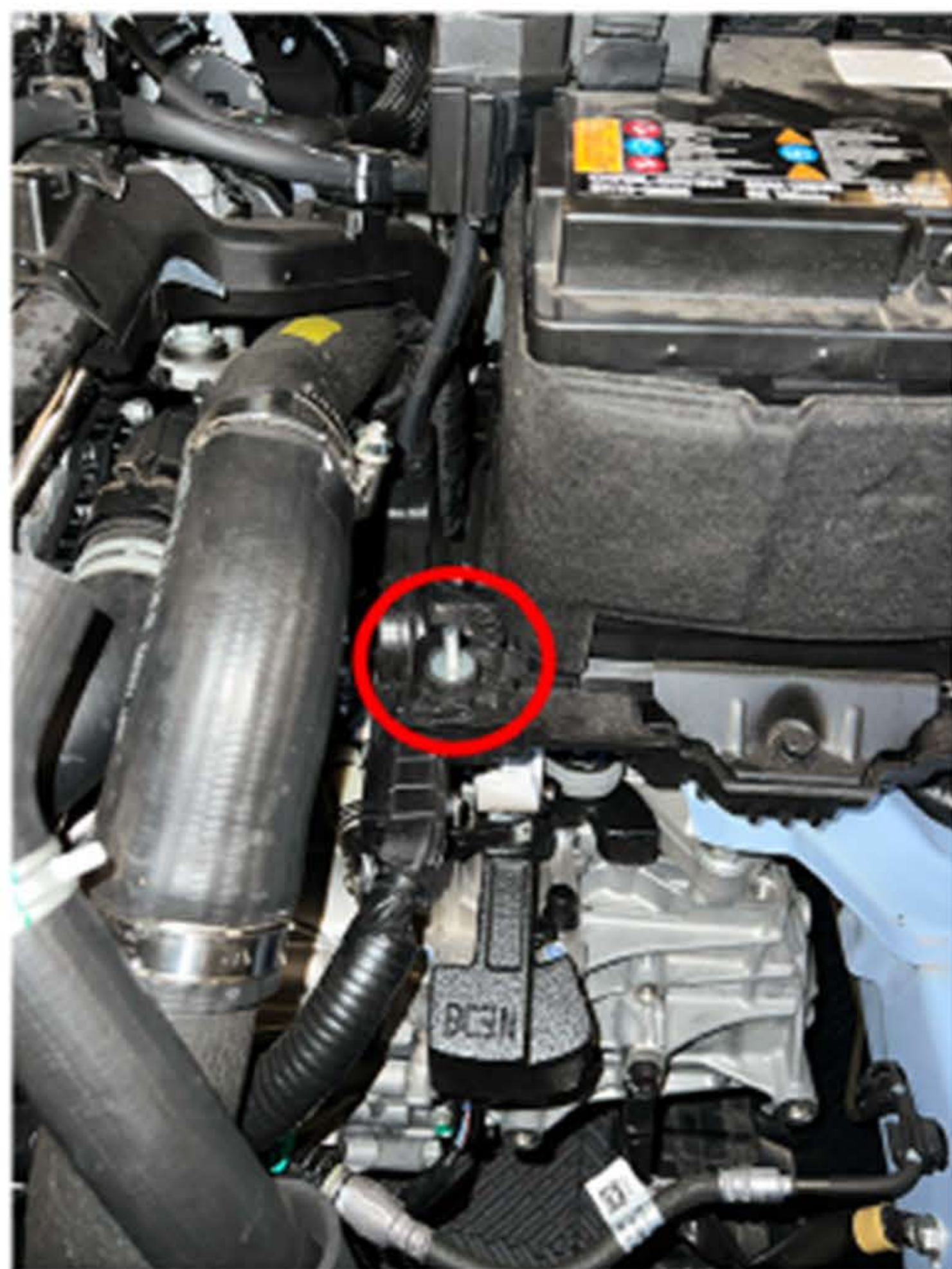

STEP 8

REMOVE THE BOLT HIGHLIGHTED



STEP 9

FIT THE HEAT SHIELD TO THE CAR USING 1X ORIGINAL BOLT AND 1X NYLON LOCKING NUT AS PICTURED.



STEP 10

BOLT THE FRONT OF THE HEAT SHIELD TO THE CAR USING THE BOLT PICTURED BELOW.

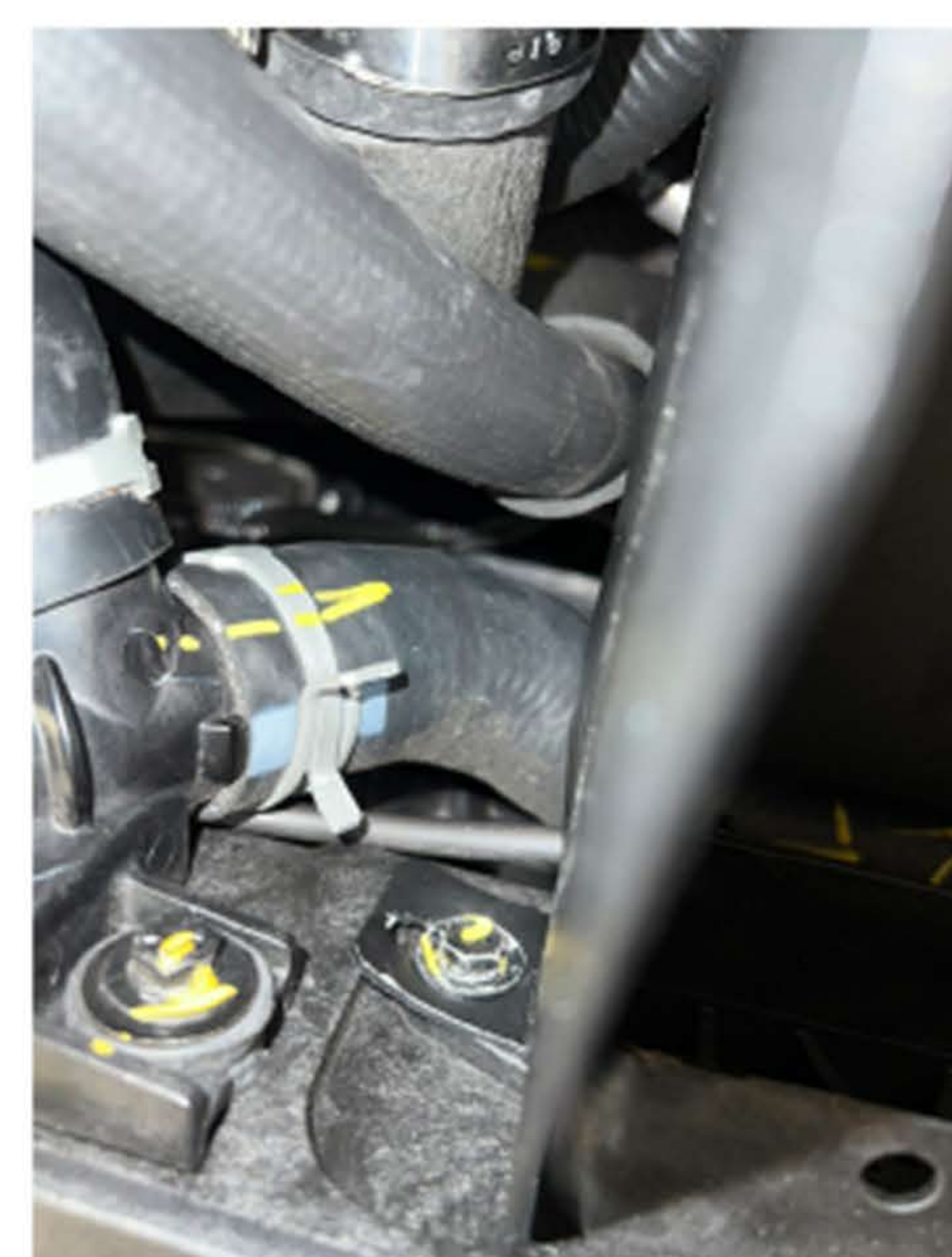

STEP 11

ATTACH THE SILICONE REDUCER PROVIDED TO THE TURBO USING THE 50-70MM JUBILEE CLIP.



STEP 12

ATTACH THE INTAKE PIPE TO THE SILICONE REDUCER DON'T TIGHTEN JUBILEE CLIP UNTIL STEP 12 IS COMPLETED



STEP 13

USING THE ORIGINAL BOLT AND INCLUDED M6 WASHER, LOOSELY BOLT THE INTAKE PIPE AS PICTURED



STEP 14

ATTACH THE 2 PIPES BACK TO THE INTAKE PIPE AS PICTURED BELOW.



STEP 15

ATTACH THE SILCONE JOINER TO THE INTAKE PIPE AND THE FILTER USING THE 70MM-90MM JUBILEE CLIPS PROVIDED.



STEP 16

MAKE SURE ALL JUBILEE CLAMPS ARE TIGHT, TIGHTEN THE BOLT SECURING THE INTAKE PIPE TO 12N.M

